

MHS 501-18-D

water-cooled

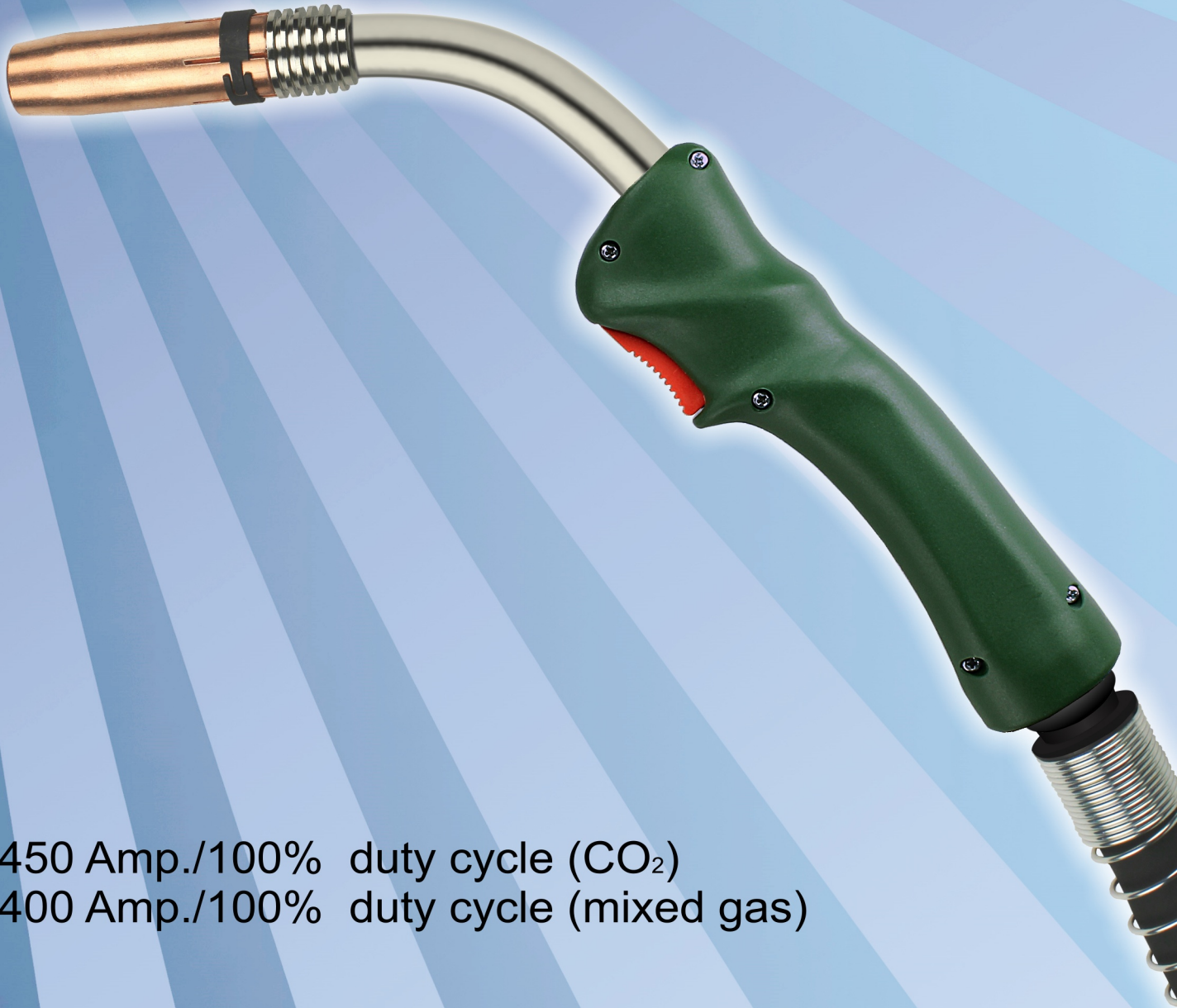

450 Amp./100% duty cycle (CO₂)
400 Amp./100% duty cycle (mixed gas)

Spare parts like:
MHS 35-D gas-cooled

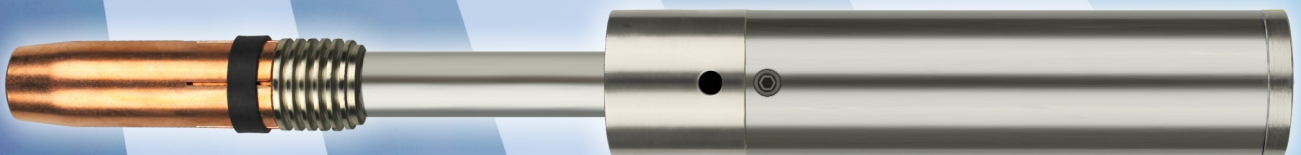

MHS 501-18-D

water-cooled



Torch body

part No. 50191001

Insulating disc

Ball joint
part No. 91912704

Ratio-handle with ball joint
part No. 91912535

Industry-handle with ball joint
part No. 91912102

Insulating disc
part No. 50191241

Contact tip holder IG-M8
part No. 50198001

Contact tip holder IG-M6
for narrow-gap contact tip
part No. 50198101

Gas diffuser
part No. 50191201

Ceramic-gas diffuser
part No. 50191203

Narrow-gap contact tip M6-L83-AD6 0,8-1,0mm
part No. 68310101
Narrow-gap contact tip M6-L83-AD6 1,2mm
part No. 68312101

Socket for centering the narrow-gap contact tip
part No. 91921801

Narrow-gap contact tip
M8-L85,5- D10
drilled to 6mm 1,2 mm
part No. 88551241

Contact tip M8 x 30
part No. 830□001
part No. 830□401(CuCrZr)
part No. 830□301(nickel plated)
□ Please fill in wire diameter

HSN 661-1



MHS 501-18-D water-cooled

450 Ampere at 100% duty cycle (CO₂) - 400 Ampere at 100% duty cycle (mixed gas)

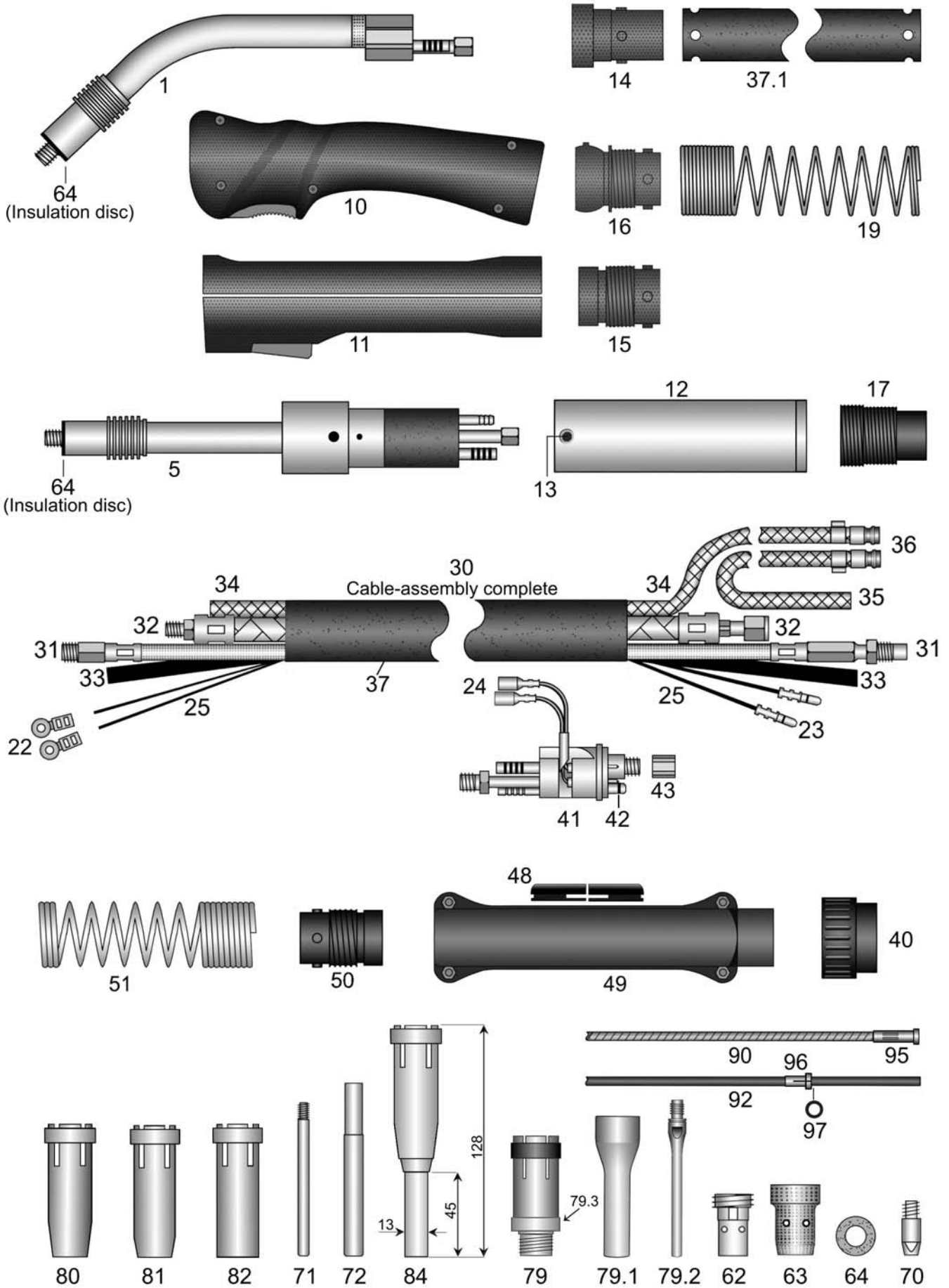

HSN 134B

MHS 501-18-D

Welding-torch MIG-MAG water-cooled

450A at 100% duty cycle (CO2) - 400A at 100% duty cycle (mixed gas)

Art.-No.

Spare parts as torch MHS 35-D gas-cooled

50100311	Torch MHS 501-18-D / 3m EURO central adapter
50100411	Torch MHS 501-18-D / 4m EURO central adapter
50100511	Torch MHS 501-18-D / 5m EURO central adapter
50105311	AUTomatic-torch MHS 501-18-D / 3m EURO central adapter

**For torches without EURO central-adapter the following prices apply.
Please note that for some special machine side connections surcharges may arise,
which you will find in the appendix "A" custom made products.**

50100301	Torch MHS 501-18-D / 3m
50100401	Torch MHS 501-18-D / 4m
50100501	Torch MHS 501-18-D / 5m
50105301	AUTomatic-torch MHS 501-18-D / 3m

**Special lengths for hand- and AUTomatic-torches
please notice appendix "B".**

**Torches with flexible and highly heat resistant cable assemblies available for small
surcharges! Please see appendix "B"**

pg000001	Surcharge: Pistol-shape-handle / stabilizer
N.i. 91912453	Heat protection shield for pistol handle, screws included
29004602	Surcharge: Torch body with custom bending
91900102	Adapter EURO central adapter fits power source with Dinse central adapter

**All torch bodies and AUTomatic torch bodies with teflon insulation,
nickel coated brazen outer tube with cooling ribs,
max. cooling water conduits, very massive power conduit,
complete with contact tip holder M8 and insulator disc.**

2	50191001	Torch body MHS 501-18-D with cooling ribs
5	50191501	AUTomatic-torch body MHS 401/501-18-D

**Handles complete with switch and screws
Ball joints or sockets are also included**

10	91912535	Ratio-handle 18mm with ball joint
10	91912435	Ratio-handle 18mm (**without ball joint**)
N.i.	91912438	Ratio microswitch DC2
N.i.	91912439	Push button red for Ratio handle also fits RAUCH handle
N.i.	91912441	Spring fits button Ratio grip handle and RAUCH grip handle
11	91912102	Industry-handle 18mm with ball joint
11	91912331	Industry-handle 18mm (**without ball joint**)
N.i.	91920411	Switch-set fits industry-handle for 16/18/20mm (11 parts)
N.i.	91920702	Screw M3x11,5mm fits Ratio/Industry/RAUCH handle and cable support
N.i.	91920703	M3 mounting socket fits Ratio/Industry/RAUCH handle and cable support

12	91912921	AUT handle tube, brass-cladded AD38mm for AUT-torch standard
13	91912911	Holding screw M4x6mm for AUT handle tube OD38mm
14	50191251	Rubber cable-support RETRO
15	91912701	Spring socket pistol side fits handle without ball joint

MHS 501-18-D

Welding-torch MIG-MAG water-cooled

450A at 100% duty cycle (CO₂) - 400A at 100% duty cycle (mixed gas)

Art.-No.		
16	91912704	Spring socket pistol side fits handle with ball joint
17	91912711	AUT spring socket
19	91912501	Cable support spring pistol-side fits water-cooled torches
N.i.	91912511	AUT cable support spring (long design)
N.i.	91912521	AUT suspension spring
N.i.	91912531	AUT carabiner
N.i.	10089001	Single stroke button (rubber)
22	91902811	Cable-plug fits industry-handle
23	91902901	Male connector cable-plug for machine side EURO central adapter
24	91903001	Female connector cable-plug fits machine side EURO central adapter
25	91902423	Meter control line 2x0,75mm ² red free of halogen (100m)
Spare cable-assemblies complete with cable support springs and fittings. Fits handles with or without ball joint - please specify!		
30	09200312	Spare cable assembly 3m / without EURO central adapter
30	09200412	Spare cable assembly 4m / without EURO central adapter
30	09200512	Spare cable assembly 5m / without EURO central adapter
Supply lines and thermo-hoses, superflexible and highly heat resistant please see appendix "C" and "D"		
31	0950a311	Wire conduit flexible MHS / 3m EURO central adapter (flexible)
31	0950a411	Wire conduit flexible MHS / 4m EURO central adapter (flexible)
31	0950a511	Wire conduit flexible MHS / 5m EURO central adapter (flexible)
32	09400311	ST 80 PVC-NIT power/water cable MHS / 3m EURO central adapter
32	09400411	ST 80 PVC-NIT power/water cable MHS / 4m EURO central adapter
32	09400511	ST 80 PVC-NIT power/water cable MHS / 5m EURO central adapter
Supply lines for AUTomatic torches.		
31	0950d311	AUT wire conduit MHS / 3m EURO central adapter white (hard)
32	09400313	HT 110 rubber fabric hose power/water cable MHS / 3m EURO central adapter
Reel goods: Prices are per meter and only applicable if a complete reel is purchased.		
33	41500001	Meter ST 70 PVC hose ID4,0-W1,5mm black for gas (100m)
34	50170001	Meter ST 80 PVC-NIT fabric hose ID5,0-W1,7mm blue for water (100m) robust model, thick-walled and non-buckling
35	50171001	Meter ST 80 PVC-NIT fabric hose ID5,0-W1,7mm red for water (100m) robust model, thick-walled and non-buckling
36	91901001	Cooling liquid plug nipples EURO
N.i.	91901008	Closing cap blue fits cooling liquid plug nipples EURO
N.i.	91901009	Closing cap red fits cooling liquid plug nipples EURO
37	25151001	Meter rubberized fabric protective hose ID25-W1,5mm (40m)
37.1	25151311	Rubberized fabric protective hose ID25-W1,5mm perforated fits 3m / EURO central adapter
37.1	25151411	Rubberized fabric protective hose ID25-W1,5mm perforated fits 4m / EURO central adapter
37.1	25151511	Rubberized fabric protective hose ID25-W1,5mm perforated fits 5m / EURO central adapter
40	91900701	Terminal nut insulated fits EURO central adapter

MHS 501-18-D

Welding-torch MIG-MAG water-cooled

450A at 100% duty cycle (CO2) - 400A at 100% duty cycle (mixed gas)

Art.-No.		
41	91900201	Central adapter fixed contact-pins EURO central adapter
41	91900206	Central adapter spring contact-pins EURO central adapter
42	91900801	O-ring ID4-W1mm fits gas-nipple EURO central adapter
43	91900901	Swivel nut IT-M10x1 (rounded edges) fits EURO central adapter
48	91901011	Rubber-hose-fence fits cable support
49	91900561	Cable support machine side (screws included) fits EURO central adapter
N.i.	91920702	Screw M3x11,5mm fits Ratio/Industry/RAUCH handle and cable support
N.i.	91920703	M3 mounting socket fits Ratio/Industry/RAUCH handle and cable support
N.i.	91900601	Attachment screw M4x6mm fits cable support EURO central adapter
50	91912801	Spring-socket fits cable support
51	91912601	Cable support spring
62	50198001	Contact tip holder IT-M8 AG-M16x1-L25mm
62	50198101	Contact tip holder IT-M6 AG-M16x1-L25mm (for narrow-gap contact tip M6)
63	50191201	Gas diffusor Keripol white
63	50191204	HT-gasdiffusor black power
63	50191203	Ceramic-gas diffusor
N.i.	50191243	Narrow gap-insulation ring black power
64	50191241	Insulator
70	83008001	Contact tip M8-L30-AD10 0,8
70	83010001	Contact tip M8-L30-AD10 1,0
70	83012001	Contact tip M8-L30-AD10 1,2
70	83014001	Contact tip M8-L30-AD10 1,4
70	83016001	Contact tip M8-L30-AD10 1,6
70	83020001	Contact tip M8-L30-AD10 2,0
70	83010401	Contact tip M8-L30-D10 CuCrZr 1,0
70	83012401	Contact tip M8-L30-D10 CuCrZr 1,2
70	83014401	Contact tip M8-L30-D10 CuCrZr 1,4
70	83016401	Contact tip M8-L30-D10 CuCrZr 1,6
70	83020401	Contact tip M8-L30-D10 CuCrZr 2,0
70	83008301	Contact tip M8-L30-AD10 0,8 nickel-plated
70	83010301	Contact tip M8-L30-AD10 1,0 nickel-plated
70	83012301	Contact tip M8-L30-AD10 1,2 nickel-plated
70	83014301	Contact tip M8-L30-AD10 1,4 nickel-plated
70	83016301	Contact tip M8-L30-AD10 1,6 nickel-plated
70	83008a01	Contact tip M8-L30-D10 0,8-A for aluminium wire
70	83010a01	Contact tip M8-L30-D10 1,0-A for aluminium wire
70	83012a01	Contact tip M8-L30-D10 1,2-A for aluminium wire
70	83016a01	Contact tip M8-L30-D10 1,6-A for aluminium wire
Another 2-part narrow gap system with curved gas nozzle can be combined with this torch type! Prices on request		
71	68310101	Narrow-gap contact tip M6-L83-AD6 0,8-1,0 nickel-plated
71	68312101	Narrow-gap contact tip M6-L83-AD6 1,2 nickel-plated
72	91921801	Narrow-gap centering wrench for contact tip M6-L83-D6mm
79	50193362	Narrow gap-gasnozzle lower part, nickel-coated with PTFE insulation ring
79.1	50193364	cylinder (nickel plated) for narrow gap-gasnozzle ID11-AD14mm fits lower part

MHS 501-18-D

Welding-torch MIG-MAG water-cooled

450A at 100% duty cycle (CO2) - 400A at 100% duty cycle (mixed gas)

Art.-No.		
79.1	50193365	cylinder (nickel plated) for narrow gap-gasnozzle ID12-AD15mm fits lower part
79.2	88551241	Narrow gap-contact tip M8-L85,5-D10 turned down to 6mm 1,2 CuCrZr
79.2	88551041	Narrow gap-contact tip M8-L85,5-D10 turned down to 6mm 0,8 - 1,0 CuCrZr
79.3	50193363	PTFE-seal fits narrow gap-gasnozzle lower part
Gas nozzles		
80	50193201	Gas nozzle conical-ID14mm
81	50193001	Gas nozzle conical-ID16mm
82	50193301	Gas nozzle cylindric-ID19mm
84	50193361	Narrow-gap gas nozzle with cylinder ID11-AD13-L45mm (overall length 128mm)
Spirals and liners also available in other sizes on inquiry!		
90	20450311	Guide spiral-liner ID2,0-AD4,5 fits 3m / EURO central adapter
90	20450411	Guide spiral-liner ID2,0-AD4,5 fits 4m / EURO central adapter
90	20450511	Guide spiral-liner ID2,0-AD4,5 fits 5m / EURO central adapter
Guide spirals		
90	25450311	Guide spiral-liner ID2,5-AD4,5 fits 3m / EURO central adapter
90	25450411	Guide spiral-liner ID2,5-AD4,5 fits 4m / EURO central adapter
90	25450511	Guide spiral-liner ID2,5-AD4,5 fits 5m / EURO central adapter
PTFE-carbon core liners		
92	20393311	PTFE-carbon core liner ID2,0-AD3,9 fits 3m / EURO central adapter
92	20393411	PTFE-carbon core liner ID2,0-AD3,9 fits 4m / EURO central adapter
92	20393511	PTFE-carbon core liner ID2,0-AD3,9 fits 5m / EURO central adapter
PTFE-carbon core liners (longer)		
92	27473311	PTFE-carbon core liner ID2,7-AD4,7 fits 3m / EURO central adapter
92	27473411	PTFE-carbon core liner ID2,7-AD4,7 fits 4m / EURO central adapter
92	27473511	PTFE-carbon core liner ID2,7-AD4,7 fits 5m / EURO central adapter
Carbon-PA core liners		
92	20406311	Carbon-PA core liner ID2,0-AD4,0 fits 3m / EURO central adapter
92	20406411	Carbon-PA core liner ID2,0-AD4,0 fits 4m / EURO central adapter
92	20406511	Carbon-PA core liner ID2,0-AD4,0 fits 5m / EURO central adapter
Carbon-PA core liners (longer)		
92	23476311	Carbon-PA core liner ID2,3-AD4,7 fits 3m / EURO central adapter
92	23476411	Carbon-PA core liner ID2,3-AD4,7 fits 4m / EURO central adapter
92	23476511	Carbon-PA core liner ID2,3-AD4,7 fits 5m / EURO central adapter
Carbon-PA core liners (longer)		
92	29476311	Carbon-PA core liner ID2,9-AD4,7 fits 3m / EURO central adapter
92	29476411	Carbon-PA core liner ID2,9-AD4,7 fits 4m / EURO central adapter
92	29476511	Carbon-PA core liner ID2,9-AD4,7 fits 5m / EURO central adapter
ULTRA-liners (brown)		
92	20404311	ULTRA-liner (brown) ID2,0-OD4,0 fits 3m / EURO central adapter
92	20404411	ULTRA-liner (brown) ID2,0-OD4,0 fits 4m / EURO central adapter
92	20404511	ULTRA-liner (brown) ID2,0-OD4,0 fits 5m / EURO central adapter
ULTRA-liners (brown) (longer)		
92	23474311	ULTRA-liner (brown) ID2,3-OD4,7 fits 3m / EURO central adapter
92	23474411	ULTRA-liner (brown) ID2,3-OD4,7 fits 4m / EURO central adapter
92	23474511	ULTRA-liner (brown) ID2,3-OD4,7 fits 5m / EURO central adapter
ULTRA-liners (brown) (longer)		
92	29474311	ULTRA-liner (brown) ID2,9-OD4,7 fits 3m / EURO central adapter
92	29474411	ULTRA-liner (brown) ID2,9-OD4,7 fits 4m / EURO central adapter
92	29474511	ULTRA-liner (brown) ID2,9-OD4,7 fits 5m / EURO central adapter

MHS 501-18-D

Welding-torch MIG-MAG water-cooled

450A at 100% duty cycle (CO₂) - 400A at 100% duty cycle (mixed gas)

Art.-No.		
N.i.	20405002	Brass spiral liner (marked blue) ID2,0-OD4,0mm L300mm fits liner OD3,9/4,0mm
N.i.	20405001	Brass spiral liner (marked green) ID2,0-OD4,0mm L300mm fits liner OD4,7mm
N.i.	25405002	Bronze spiral liner (marked blue) ID2,5-OD4,0mm L300mm fits liner OD3,9/4,0mm
N.i.	25405001	Bronze spiral liner (marked green) ID2,5-OD4,0mm L300mm fits liner OD4,7mm
95	91905721	Nipple (brass L-30mm) fits spiral liner EURO central adapter AD4,5mm
96	91906111	Nipple fits core liner EURO central adapter AD3,9/4,0mm
96	91906121	Nipple fits core liner EURO central adapter AD 4,7mm
97	91906131	O-ring ID3,5-W1,5mm fits core liners
N.i.	91906112	Support tube, brass ID4,4 - AD5,0 - L200mm